

St Johns Estate Public Realm off New Quay Street, Manchester

Premises Licensing, Manchester City Council

© Crown copyright and database rights 2018. Ordnance Survey 100019568.

Section of plan as submitted by applicant showing areas to be licensed:

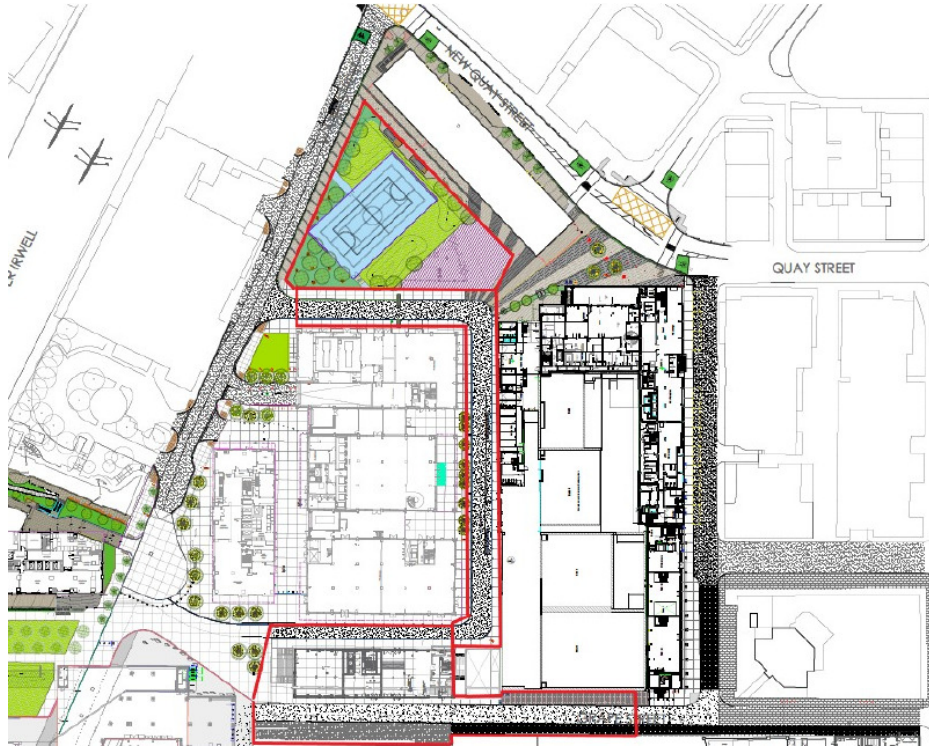

GIS map of wider area:



PREMISE NAME:	St Johns Estate Public Realm
PREMISE ADDRESS:	Public Realm, River Irwell, New Quay Street, Manchester
WARD:	Deansgate
HEARING DATE:	25/09/2023